

SACE Tmax XT

- RHE_MB_XT7 - Comando a maniglia rotante metallica montato su anta XT7
- RHE_MB_XT7 - Metallic rotary handle operating mechanism door mounted XT7
- RHE_MB_XT7 - Metallischer Drehgriff-Betätigungsmechanismus Tür montiert XT7
- RHE_MB_XT7 - Mécanisme de commande à poignée rotative métallique monté sur la porte XT7
- RHE_MB_XT7 - Mecanismo de operación con manija giratoria metálica montada en la puerta XT7
- RHE_MB_XT7 - 金属旋转手柄操作机构门装 XT7

XT7

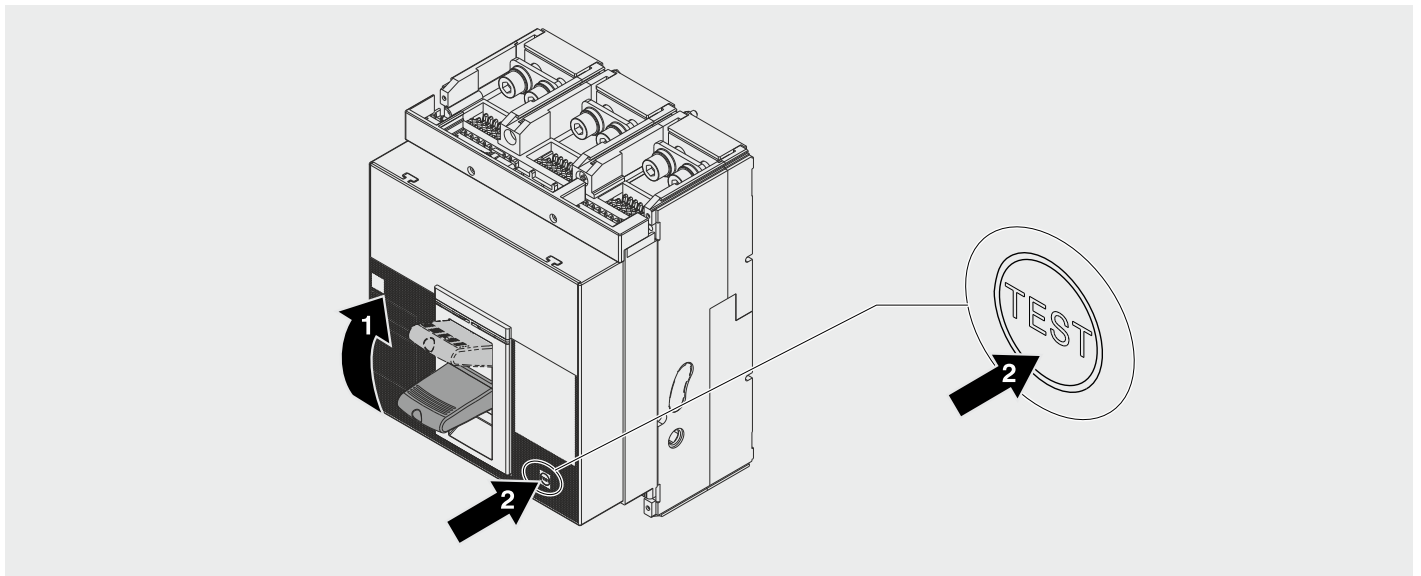





RHE_MB_XT7	1	2	1	4					1
DRIVE SHAFT (UL)				1					
DOOR HANDLE (UL)								1	2
DRIVE SHAFT (IEC)					1				
DOOR HANDLE (IEC)						1	1	2	

SAFETY NOTICE

Read these instructions carefully, and look at the equipment to become familiar with the device before trying to install, operate, service, or maintain it. The following special messages may appear in this documentation or on the equipment to warn of potential hazards or to call attention to information that clarifies or simplifies a procedure.

The addition of this symbol to a “Danger” or “Warning” safety label indicated that an electrical hazard exists which will result in personal injury if the instructions are not followed. This is the safety alert symbol. It is used to alert you to potential personal injury hazards.

	 WARNING
 	<p>IMPROPER INSTALLATION, OPERATION AND MAINTENANCE Ensure only qualified personnel install, operate, service and maintain all electrical equipment. Before Installing the breaker, accesories or performing and maintenance, turn the breaker off, disconnect it from any voltage sources and follow the generally accepted safety procedures.</p> <p>Failure to comply with these instructions can result in death or serious injury.</p>

	 CAUTION
	<p>IMPROPER INSTALLATION, OPERATION AND MAINTENANCE Indicates a hazardous situation and must follow installation instructions provided on how to avoid it.</p> <p>Failure to follow these instructions can result in injury or equipment damage.</p>

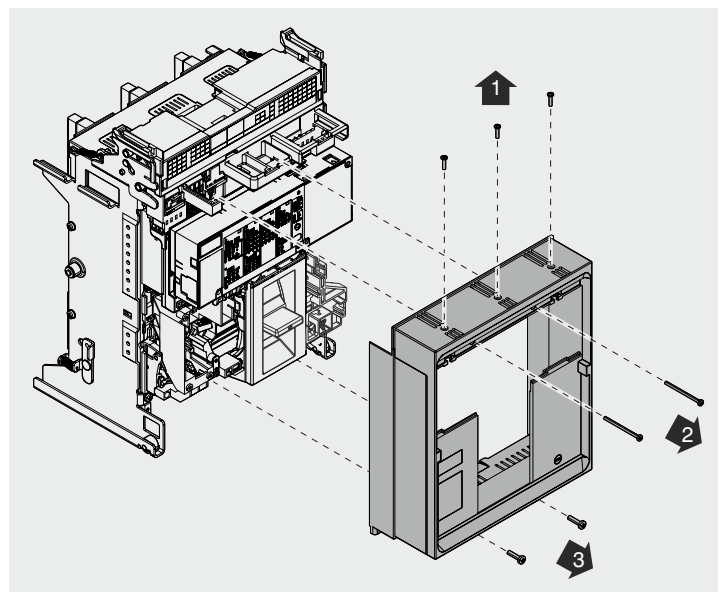
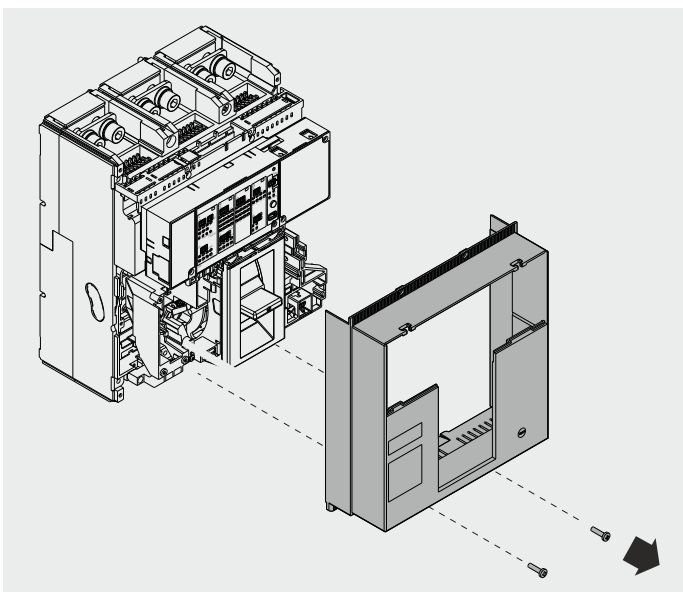
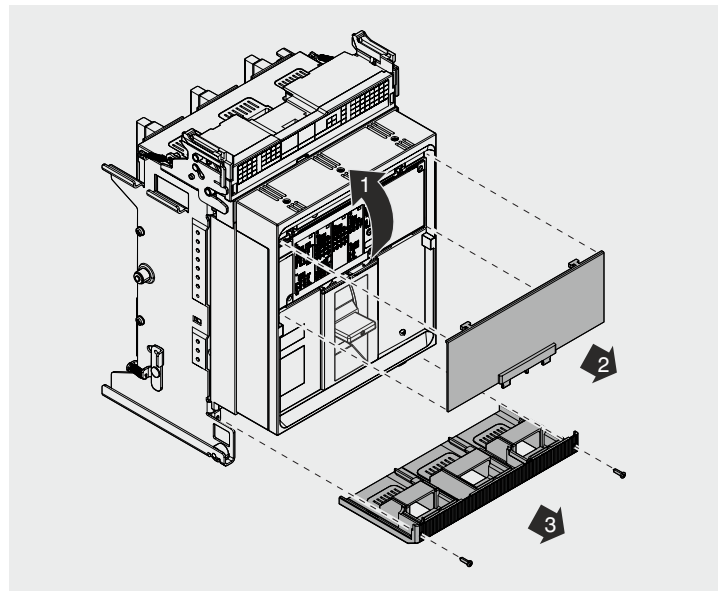
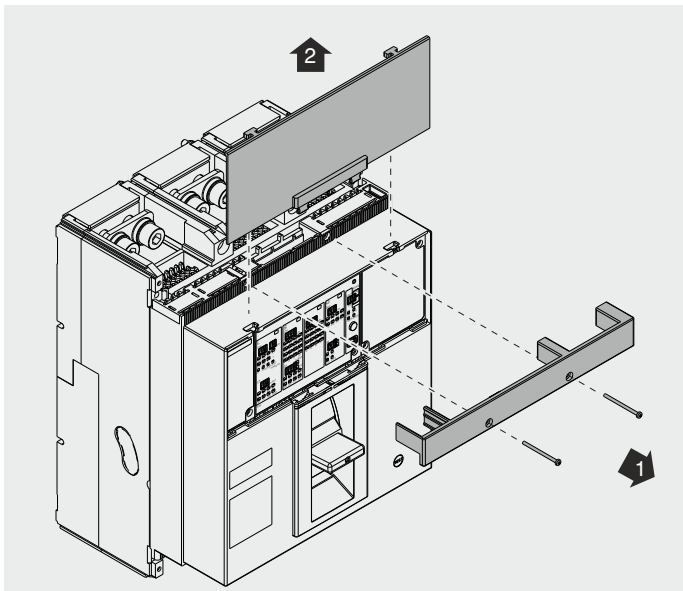
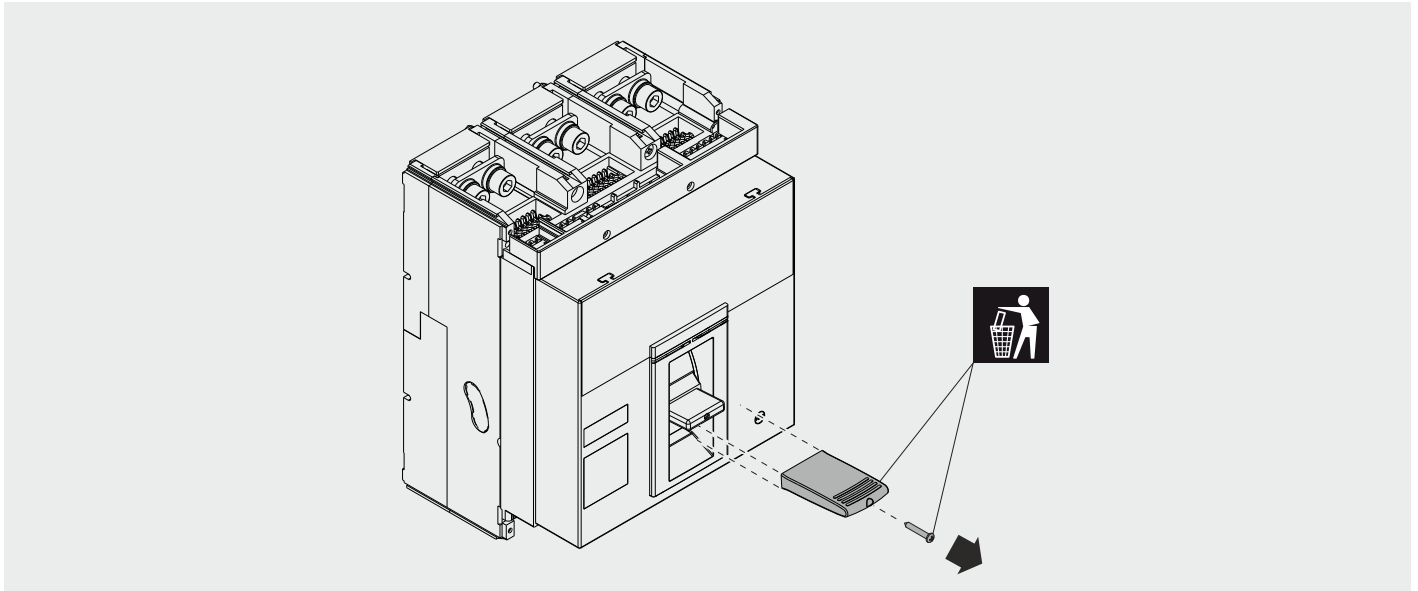

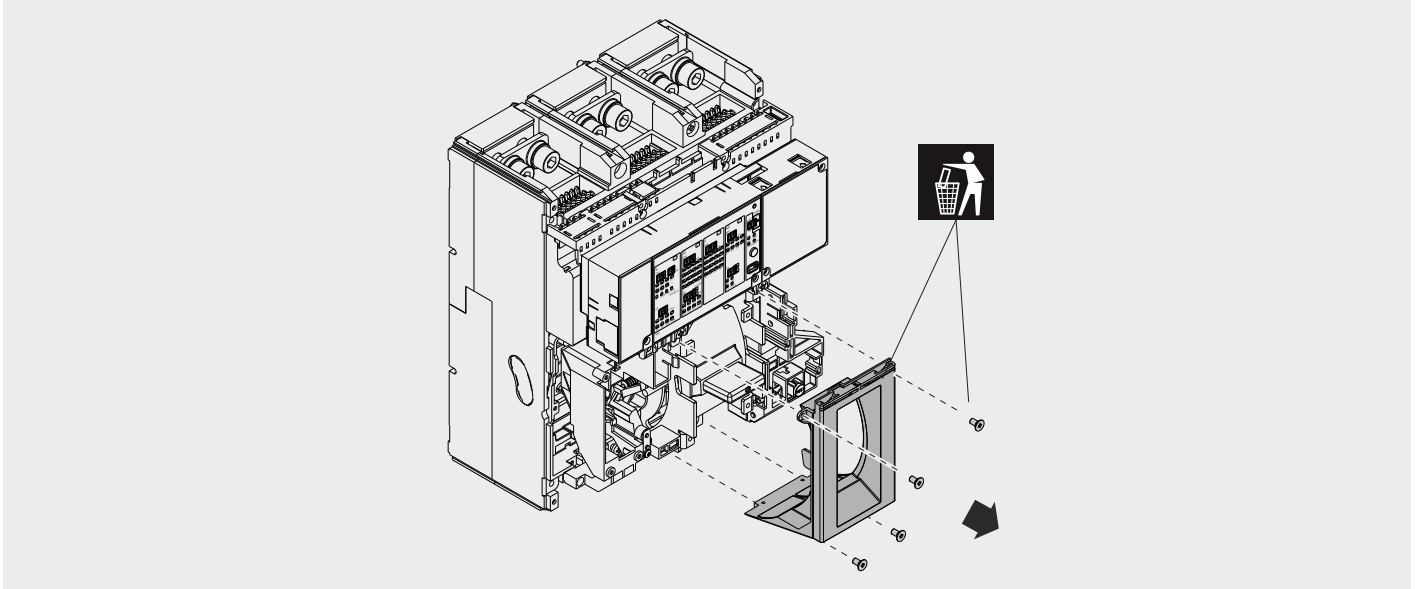

5

XT7 F

XT7 W

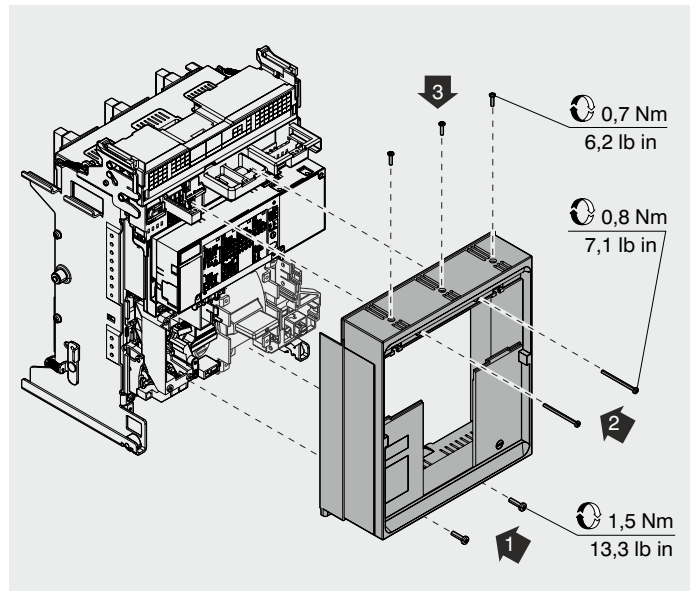
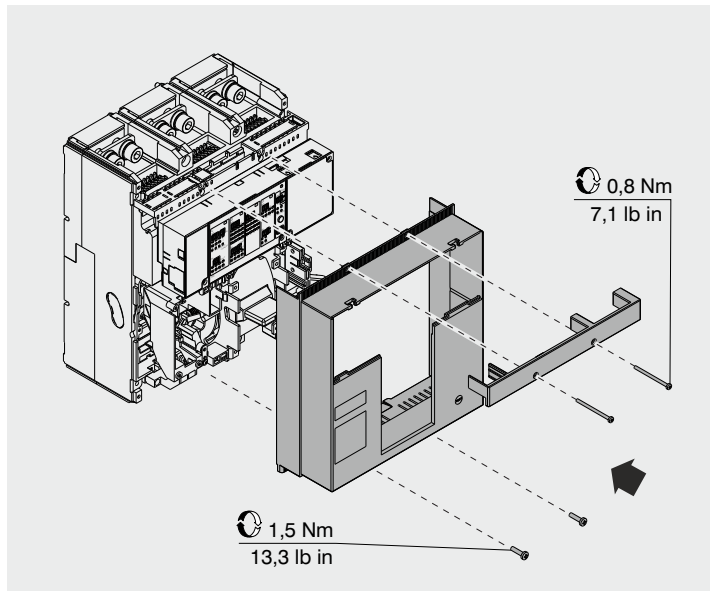

6

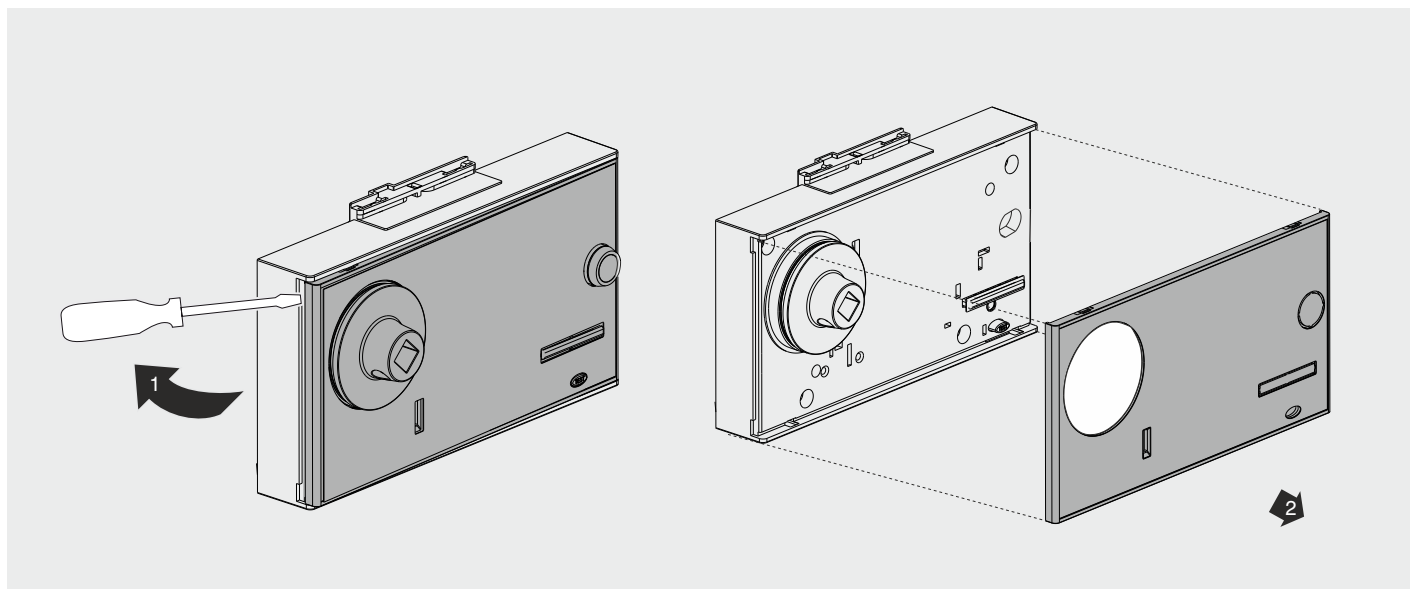

7

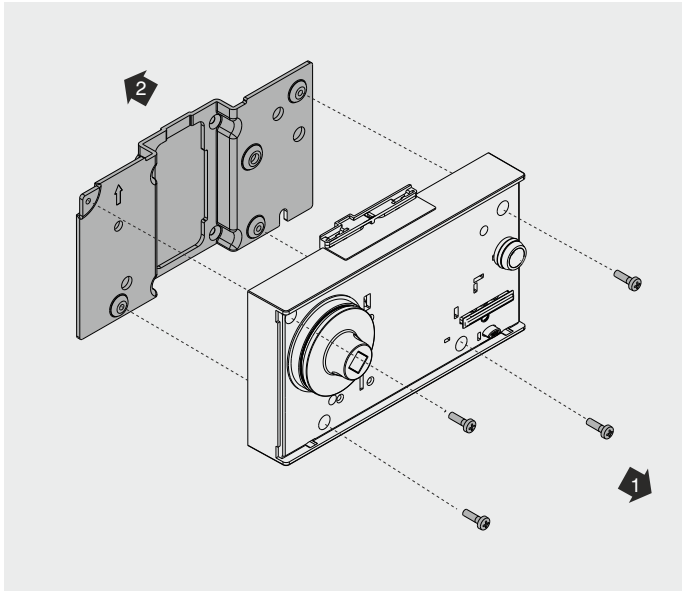

8

XT7 F/W

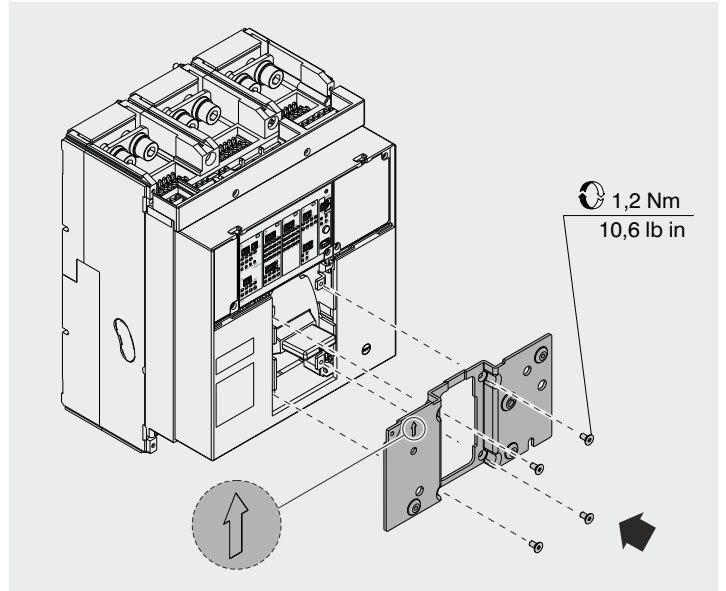

9

XT7 F/W

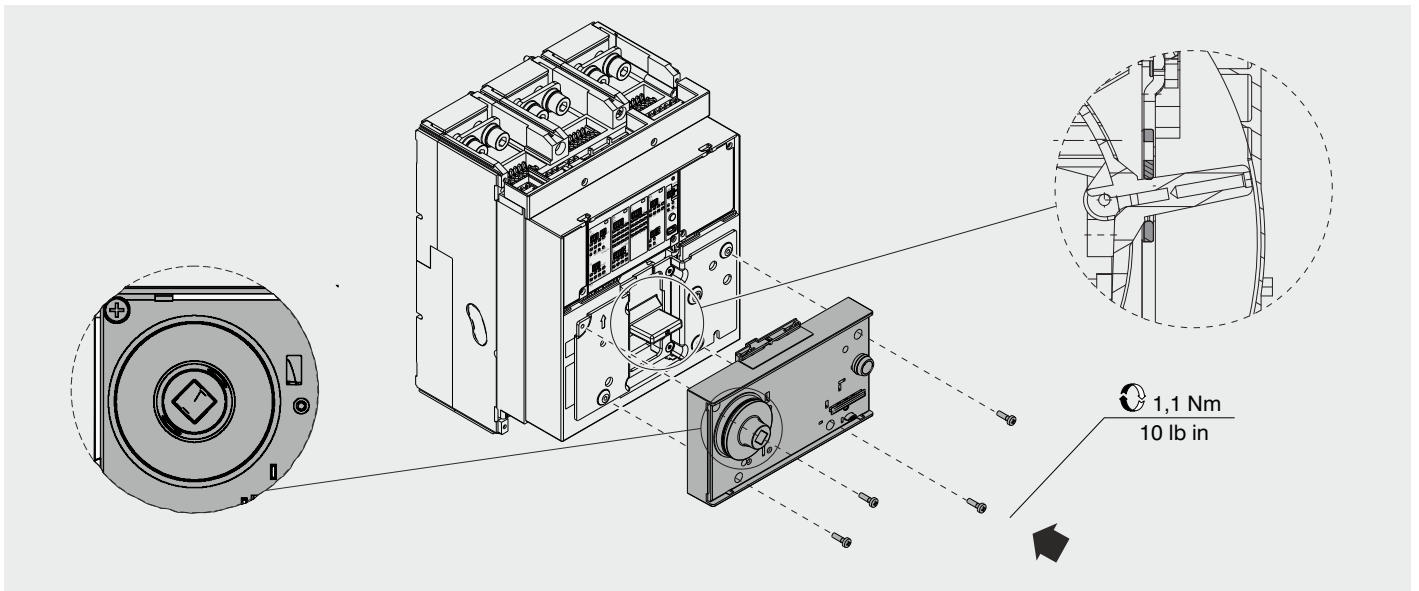

10

XT7 F/W

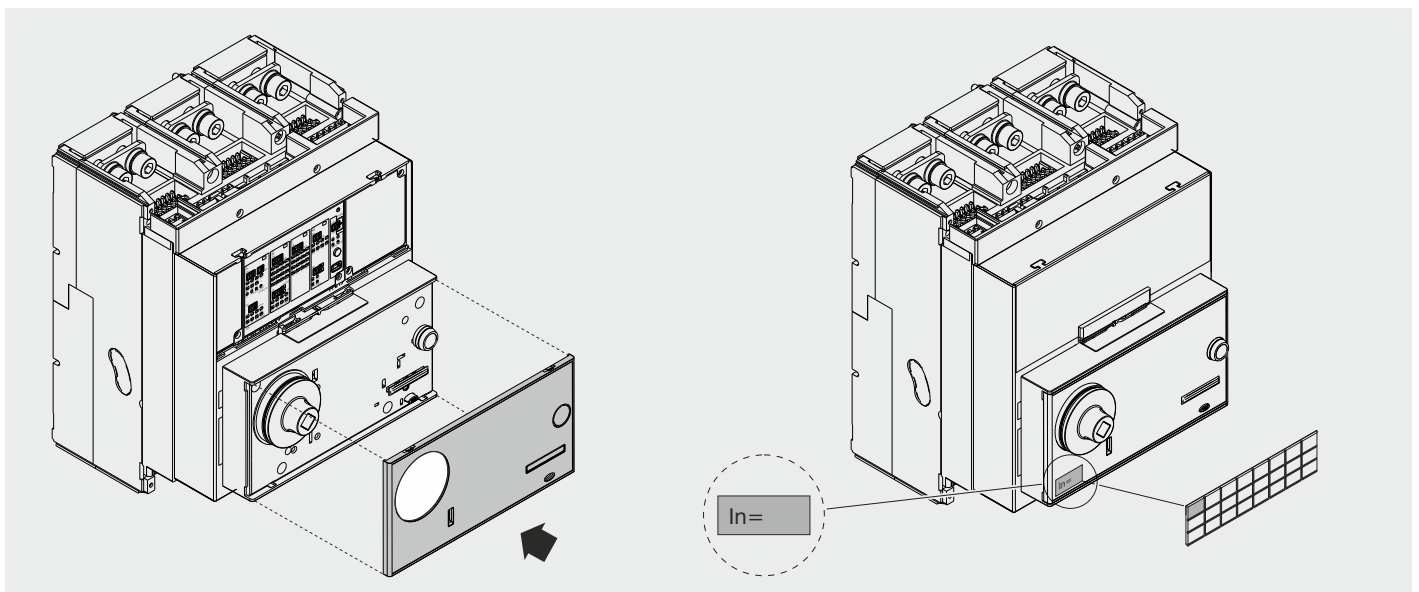

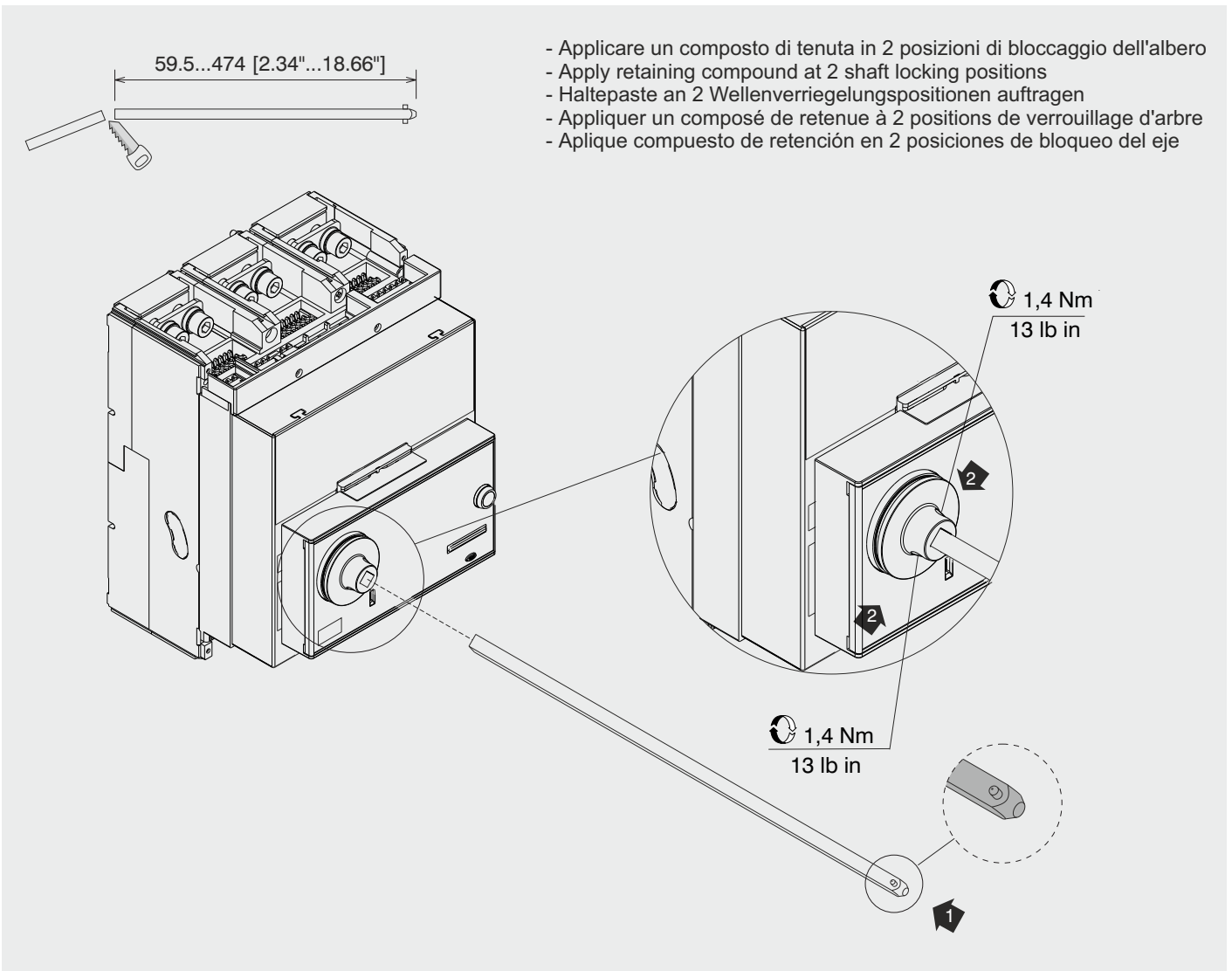
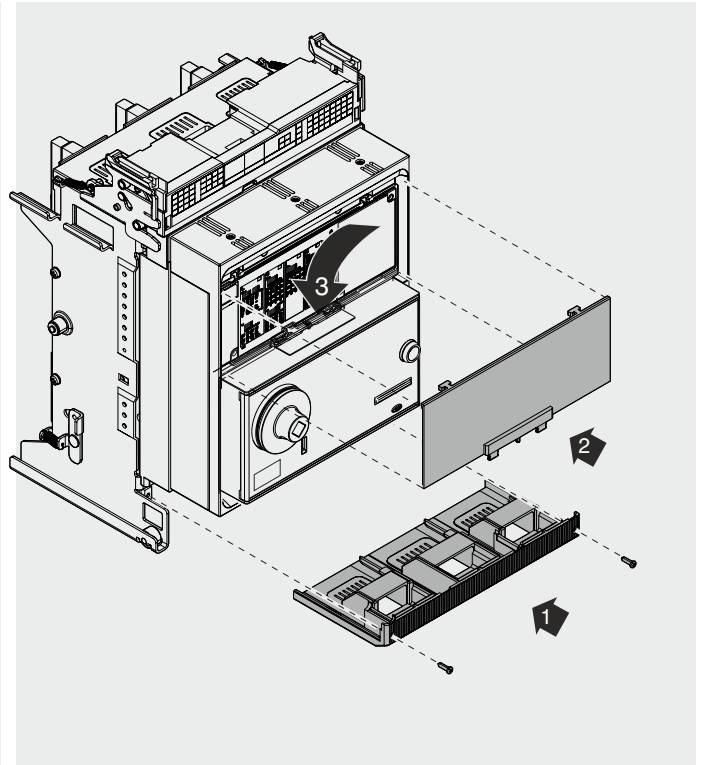
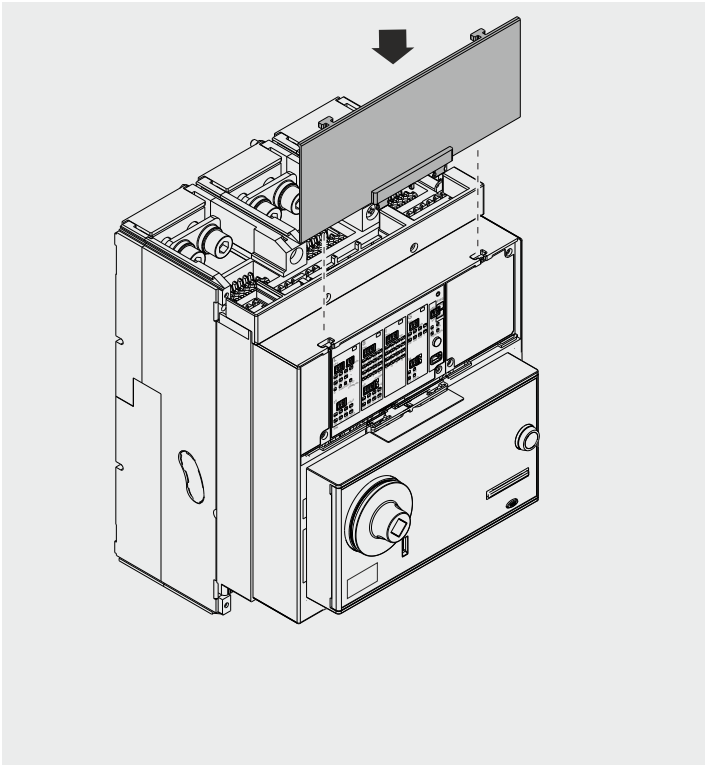

- Per la chiusura della porta mantenere la maniglia in posizione OFF
- For door closure keep Handle at OFF position
- Halten Sie den Griff zum Schließen der Tür auf OFF
- Pour la fermeture de la porte, maintenez la poignée en position OFF
- Para cerrar la puerta, mantenga la manija en la posición de APAGADO



BREAKER OFF

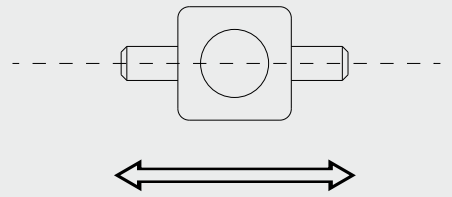

UL

IEC

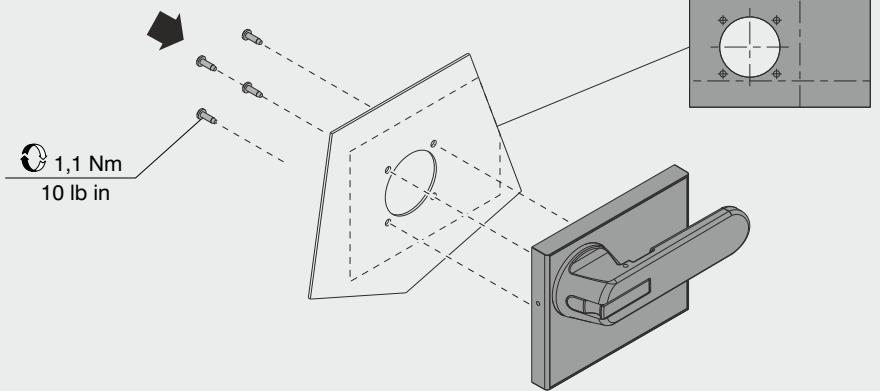
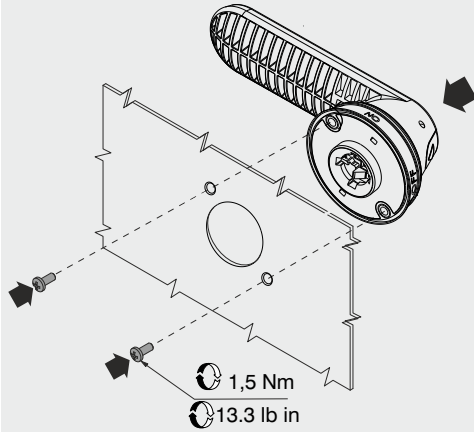

- Verificare il valore (In) prima di attaccare l'etichetta
- Check the value (In) before sticking the label
- Überprüfen Sie den Wert (In), bevor Sie das Etikett anbringen
- Vérifiez la valeur (In) avant de coller l'étiquette
- Verifique el valor (In) antes de pegar la etiqueta



UL

IEC

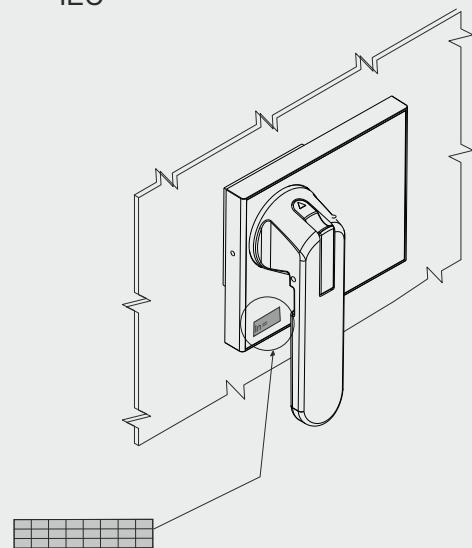
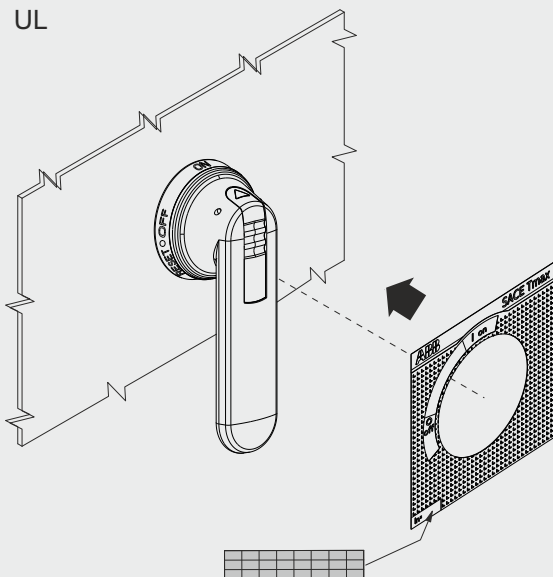

UL

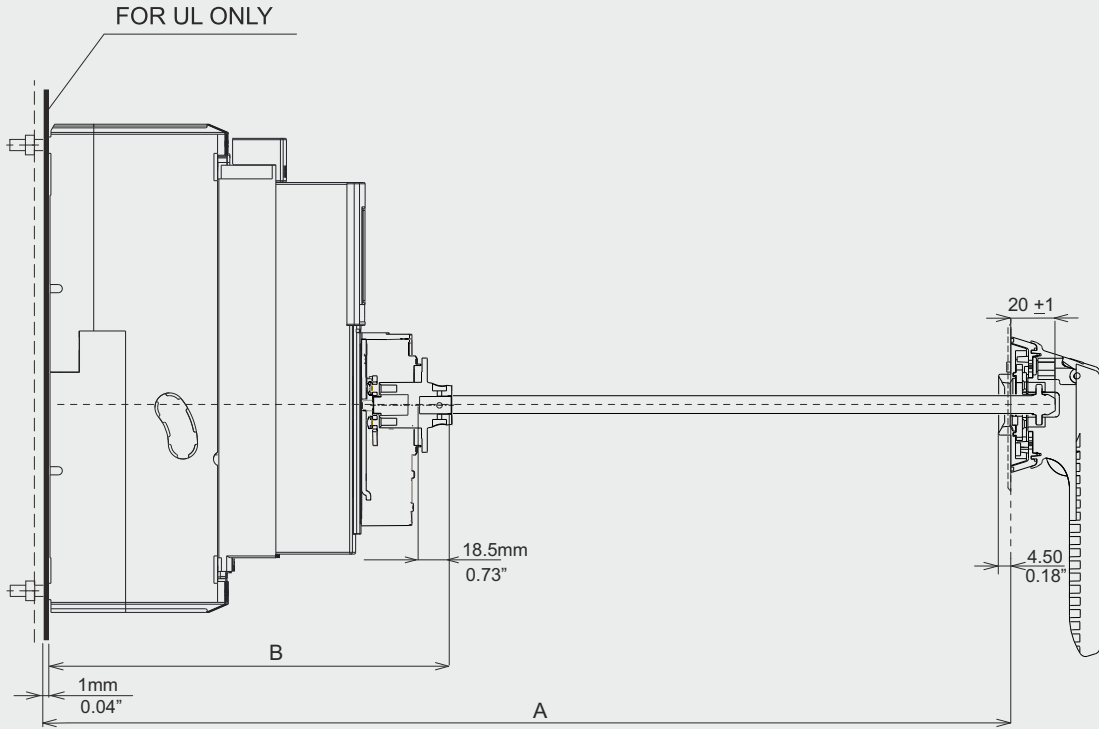

B	RHE (UL)	
	A	
[mm - in]	MIN [mm - in]	MAX [mm - in]
XT 7 220.4 - 8.68"	XT 7 242.4 - 9.54"	656.9 - 25.86"

IEC

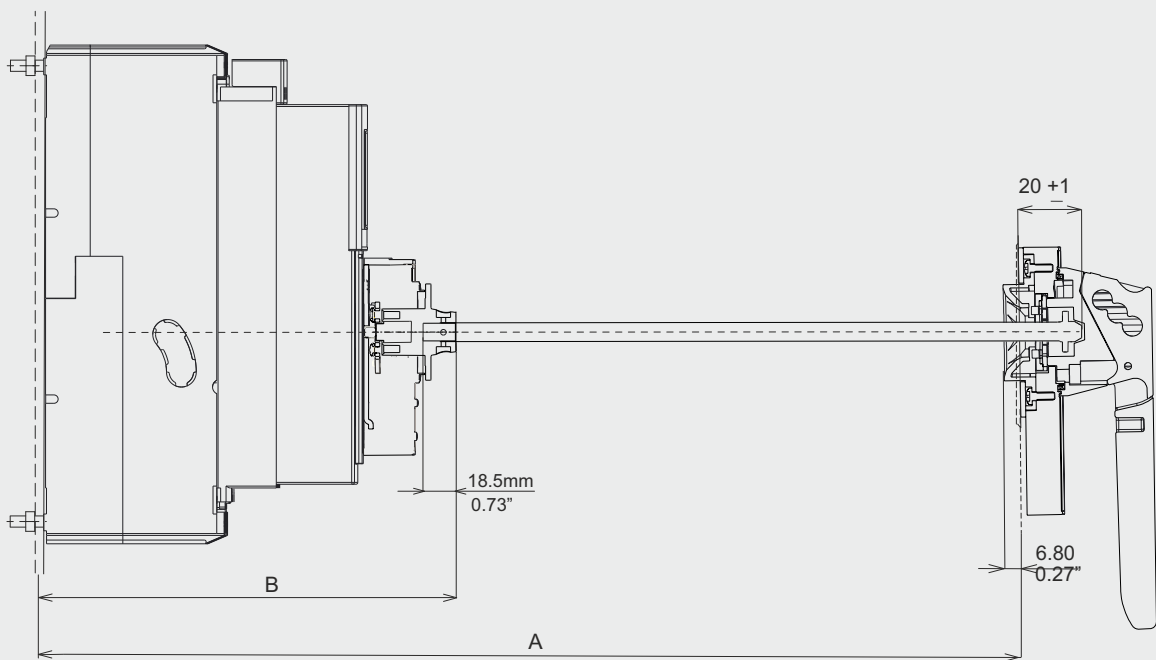

B	RHE (IEC)	
	A	
[mm - in]	MIN [mm - in]	MAX [mm - in]
XT 7 220.4 - 8.68"	XT 7 241.4 - 9.4"	655.9 - 25.82"

DOOR DRILL TEMPLATE

UL

4.2 mm
0.16 "
[2 LOCATIONS]

32.0mm
1.26"

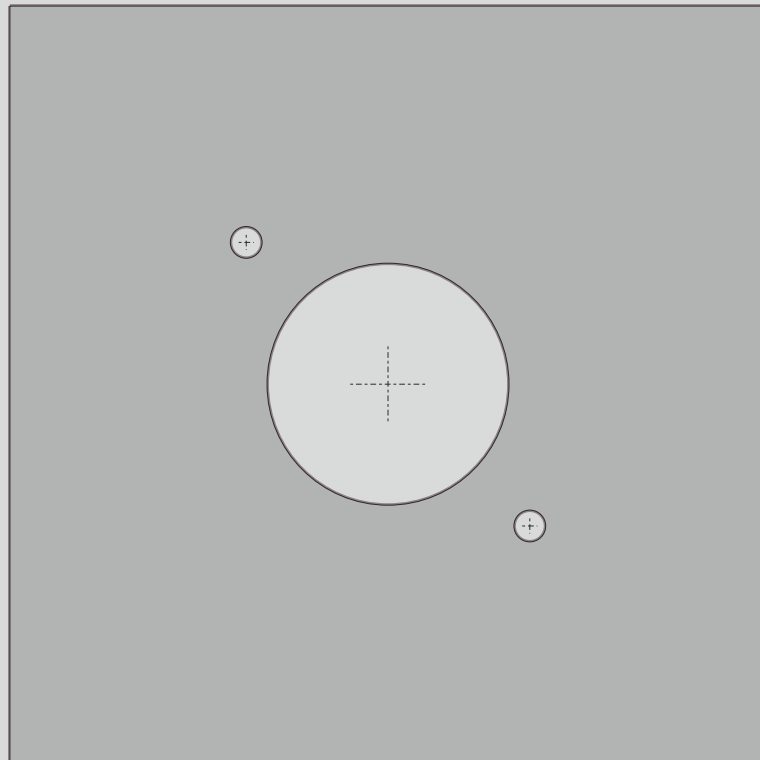
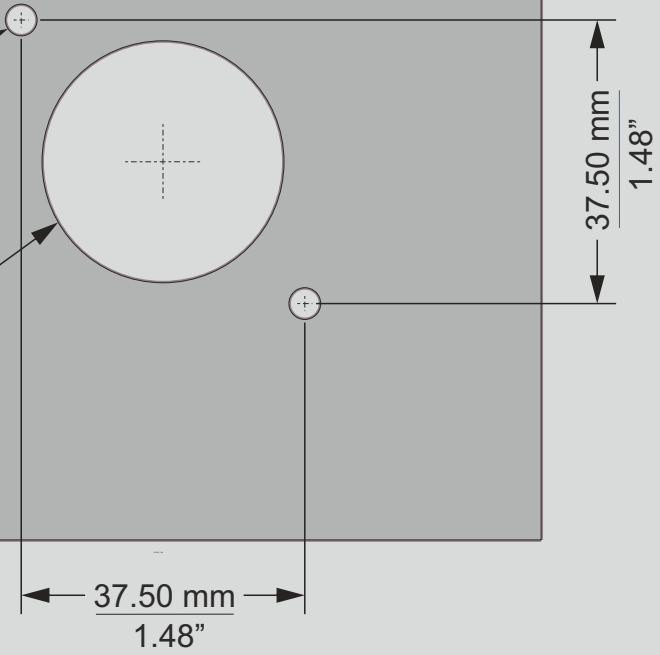

DOOR DRILL TEMPLATE

IEC

