

Surge protective device  
 Svodič přepětí  
 Zvodič prepätia  
 Ogranicznik przepięć  
 Dispozitiv de protecție la supratensiune  
 Überspannungsableiter  
 Parafoudres  
 Ограничитель перенапряжений  
 Арестор(Катодни отводители)  
 Prenaponska zaštitna jedinica  
 Viršįtampių ribotuvas  
 Пристрій захисту від перенапруги

**NOARK**

Mounting instruction  
 Montážní návod  
 Montážny návod  
 Instrukcja montażu  
 Instrucțiuni de asamblare  
 Montageanweisung  
 Instructions de montage  
 Инструкция по монтажу  
 Monteringsanvisning  
 Istruzioni di montaggio  
 Instrucciones de montaje  
 Összeszerelési útmutató  
 Asennusohjeita

Montage-instructies  
 Instruções de montagem  
 Navodila za montažo  
 Οδηγίες Εγκατάστασης  
 Инструкции за инсталиране  
 Monteringsvejledning  
 Montažu upute  
 Montavimo instrukcijos  
 Uputstvo za montažu  
 Paigaldusjuhendid  
 Інструкція з монтажу

Caution: Installation by electricians only

Varování: Montáž pouze osobou s elektrotech. kvalifikací

Varovanie: Montáž iba osobou s elektrotech. kvalifikáciou

Uwaga: Montaż tylko przez uprawnionych instalatorów





Atenție: Instalare numai de către electricieni

Vorsicht: Montagenur durch Elektrofachkräfte

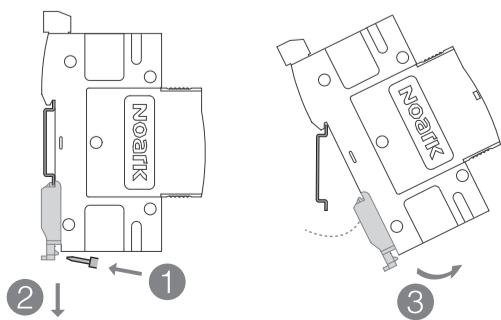
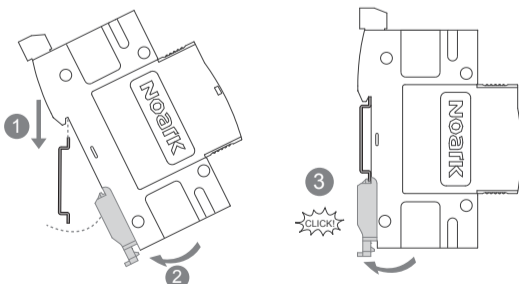
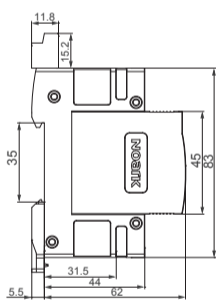
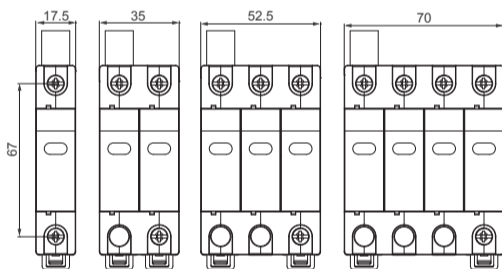

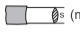

Attention: Montage uniquement par un électricien

Осторожно: Монтаж только электрика

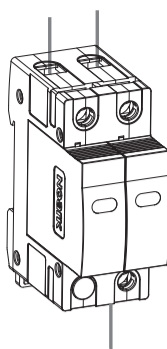

	 Z2
 s (mm <sup>2</sup> )	2.5-25mm <sup>2</sup>
 (Nm)	2-3.5Nm



	
	
AC: U <sub>max</sub> /I <sub>max</sub>	250 V / 1 A
DC: U <sub>max</sub> /I <sub>max</sub>	30 V / 1 A
 (mm <sup>2</sup> )	0.14mm <sup>2</sup> -1.5mm <sup>2</sup>

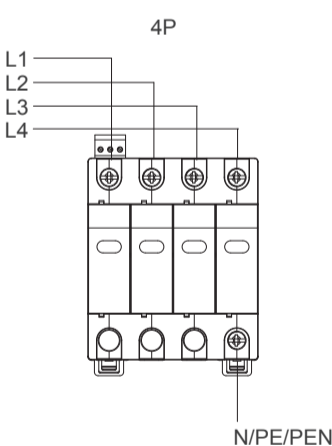
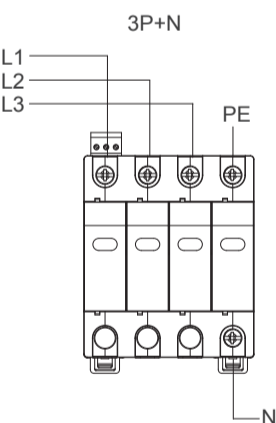
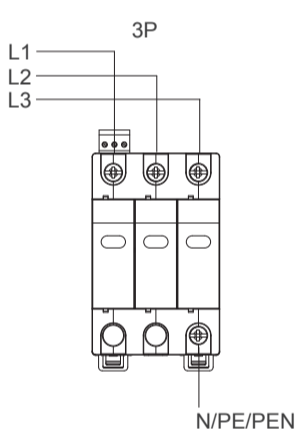
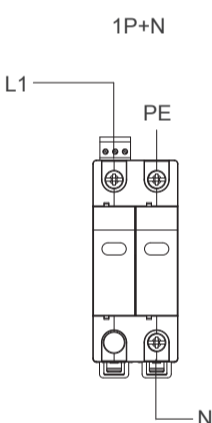
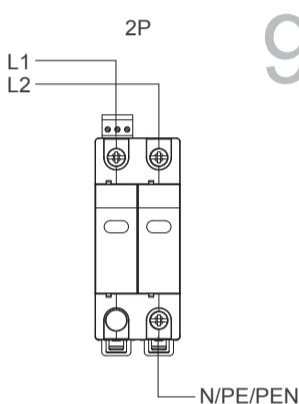
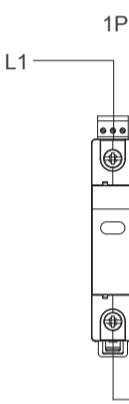
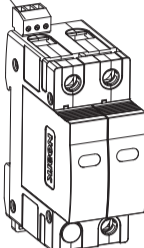
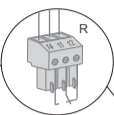

# NOARK



Printed with environment-friendly paper

Copyright Noark. All Rights Reserved

[www.noark-electric.eu](http://www.noark-electric.eu)

Z9UE1+2 201212EU